

IRVING & LILLEY
Port Hamble Marina
Satchell Lane Hamble
Southampton SO31 4QD
Tel +44 (0)23 8045 4880
Fax +44 (0)23 8045 5547
e-mail enquiries@swanyachts.co.uk
website www.swanyachts.co.uk
VAT Registration No. GB330 1366 05

SWAN 77/003

CAPERCAILLIE

LAUNCHED JUNE 1993



General Specifications:

LOA	24.68m	81ft
LWL	18.89m	62ft
Beam	6.00m	19ft7in
Draft	3.40m	11ft2in
Displacement	51 tonnes	
Ballast	18 tonnes	
Engine	Perkins 162kW/220HP	

Irving and Lilley specification Swan 77.003 Capercaillie 1 of 25 19/12/2011

Fuel Capacity 1740 litres
Water Capacity 1750 litres

Designer German Frers
Located Bari, Italy
Price 1,850,000 Euros exclusive of VAT

The Swan 77 was a response from Nautor's for the discerning owner who required a larger sailing yacht. The performance enjoyed by the racing yacht owner became accessible to those who required a very high degree of interior comfort and accommodation.

Capercaillie has an enviable reputation as a charter yacht with repeat clients every year and a crew who really know how to make sure their guests get the maximum out of their time on board. A perfect charter layout with crew and galley forward, the layout also lends itself to longer distance cruising for an owner requiring maximum privacy.

German Frers and Nautor have achieved a very special yacht with remarkable speed and power. She has the accommodation of a larger cruising boat with the agility and handling of a thoroughbred, even with a smaller crew.

Refit details 2008/09

New Microwave oven and other galley utensils.
2 new vhf portable radios
Fold- up bicycle
All new mooring lines and also halyards and sheets.
New canvas sun-awning and windscoops.
New main bilge pump & some shower drain pumps also some headpumps.
New extractor fan x 2 in engine room
New Service battery charger
New airconditioning unit in Saloon and aft guest Cabin.
2 new televisions (Samsung flatscreen) in master Cabin and also Saloon.
New Raymarine Autopilot interfaced with the Chartplotter
New Raymarine Radar interfaced with the Chartplotter.
New babystay and inner forestay

Refit details 2006/07

Reconditioned engine fitted
New running rigging throughout
New No1 Sail
Sail cover for boom modified
Refrigeration overhaul
2 x new life rafts
Replacement dinghy – AB 5.6m inflatable with 60hp outboard
Repairs to aft deck seat covers
Irving and Lilley specification Swan 77.003 Capercaillie 2 of 25 19/12/2011

Installed chart plotter
New curtains and some replacement soft furnishings, seat covers etc
Re-varnish interior in Antigua

Refit details 2004.

Complete new teak deck by HYS – Swan Service Centre
Repainted topsides and other painted surfaces
Full Osmosis treatment including rudder
Main engine and generator mounts replaced
New antifouling
New hull port lights
New toilet plumbing
All batteries tested and replaced as required
Sea cocks replaced or serviced as required
Overhaul of fuel system
Bilges treated and repainted
All sea water hoses replaced throughout
Commander hydraulic system serviced
New compass
All lenses in hatches replaced
All interior Halogen lights replaced
New sound insulation on both generator sets
New main engine exhaust line
New forward sprayhood and wind scoop
Racor fuel filters stripped and serviced
All heads serviced
A Navtec hydraulics serviced
New fresh water pumps
Full service to main engine and both generators.
Complete rig and rigging checked (whilst mast was unstepped)



HULL

CONSTRUCTION

The hull is of single skin construction using glass/aramid hybrid fibre reinforced polyester laminate

A high proportion of the fibres are unidirectional, giving a stiff laminate with excellent strength and fatigue properties

A synthetic surface mat is applied after the gel coat for increased resistance against water penetration

Engine beds are of GRP with steel inserts

FINISH

Hull colour is Blue Awlgrip - 2004

Hull stripes

Bottom treated with epoxy and primed with Blue Micron with an extra coat at the water line – full epoxy treatment by Swan Service Centre 2004.

KEEL

The standard deep ballast keel is a lead casting with antimony

Cast-in keel bolts are of high tensile stainless steel

MAST STEP

The mast is stepped through the deck onto a galvanised steel mast step

Tie rods from the mast collar to step

RUDDER AND STEERING SYSTEM

Irving and Lilley specification Swan 77.003 Capercaillie 4 of 25 19/12/2011

Rudder of foam filled GRP with high strength stainless steel stock supported by two roller bearings replaced 2005
Weed deflector in front of rudder
Cable steering gear and sheaves provided with guards to prevent jamming
Aluminium steering quadrant bolted to rudder stock
70" recessed destroyer type wheel
Pedestal with roller bearings and friction brake
Emergency tiller stowed in lazarette

THROUGH HULL FITTINGS

Sea cocks of bronze for all through hull connections below the water line, finished flush with outside and located in accessible positions
Inboard side of sea cocks fitted with stud long enough to take two hose clamps

Extended transom including two deck hatches
Bathing platform extends hull to 81 feet in transom without extension
Protection fin for rudder
Two hull windows of dark Perspex



DECK

CONSTRUCTION

Deck is of GRP sandwich construction with foam core and glued and through bolted to the hull

High density core under deck fittings

Irving and Lilley specification Swan 77.003 Capercaillie 5 of 25 19/12/2011

TEAK WOODWORK

Teak deck including teak on forward and aft coaming

Teak hatch frame, sheet and halyard cleats

Laid teak battens on bridge deck, cockpit soles and seats

Lips each side of sheet tracks



WINCHES

Winches are of Ocean Series Wavespring type

Primary sheet winches 2 x Lewmar 1130 3-2 speed linked to removable pedestals

Secondary sheet winches 2 x Lewmar 1100/3 SST, grinder pedestal driven, including hydraulic drive

Mainsheet winch 1 x Lewmar 700/3 SST - top handle driven including hydraulic drive

Traveller control 2 x Lewmar 44 CST

Running backstay 2 x Lewmar 58 SST

Genoa halyards 2 x Lewmar 66 SST hydraulic, 1 x 2-speed and 3-speed

Spinnaker halyards 2 x Lewmar 66 SST, 2-speed

Main halyard 1 x Lewmar 66 SST, 2-speed

Spinnaker pole lift 2 x Lewmar 54 CST

Additional staysail halyard and foreguyl winches 2 x Lewmar 54 CST

Commander 6-7 function 3076 including PTO interface to drive:

- 2 x secondary winches

- 1 x mainsheet

- 2 x halyard winches

- 1 x headsail furling (Reckmann RF90-3 R5 160 bar needed)

- 1 x anchor windlass

Eleven Safety switches

Recessed anchor windlass Lewmar 3000 MK2 vertical driven from the commander including remote control and one pair of Lewmar electric safety switches.

Irving and Lilley specification Swan 77.003 Capercaillie 6 of 25 19/12/2011



DECK HARDWARE

Removable deck fittings for spinnaker and jockey pole
Flush mounted stainless steel Genoa T-tracks
Flush mounted additional stainless steel Genoa T-track at station 6.8 to 7.8
Screw-in fittings at station 4, 6.5, 7 and 7.3 for additional sheeting possibilities (including eight sockets and four removable blocks)
Flush mounted stainless steel staysail T-tracks
Foot block at forward end of genoa tracks for car adjustment (Harken 508)
Two Jammers/Spinlock for spectra lines
One additional pair of fairleads on the stern
Flush mounted stanchion bases
Radar post with lifting arm on aft deck - horizontally adjustable from Navtec panel
Backstay adjuster installed under deck

OTHER FITTINGS

One winch handle holder on mast, two in aft cockpit
Teak toe rail with open roller fairleads forward, amidships and aft
16" Aluminium mooring cleats two on foredeck, two amidships, two aft
Pulpit, pushpit and lifeline stanchions 750mm high of stainless steel with bases bolted through deck
Pulpit of open type and equipped with seat
Stainless lifelines - 8mm top and bottom
Gates in lifelines each side amidships
Socket for flagpole on pushpit
Stowage for two eight-man life rafts in cockpit lockers

GRP MOULDINGS

Irving and Lilley specification Swan 77.003 Capercaillie 7 of 25 19/12/2011

Hood for companionway hatch, Dorade ventilation boxes, lazarette and cockpit stowage hatches

HATCHES AND WINDOWS

Fully flush mounted Goiot hatches - all lenses new 2001

Two hatches to forward storage space

Foredeck hatch Rondal - painted Awlgrip October 2002

Two Goiot Cristal hatches to forward toilet (flush mounted)

Two deck prisms

Four Goiot hatches to forward guest cabin toilet and galley (flush mounted and hinged at forward edge - painted Awlgrip October 2002

Two Goiot hatches to saloon (flush mounted and hinged on aft edge)

Four Goiot hatches on coaming at centre cockpit

Two Goiot hatches in centre cockpit starboard side at station 7.2 - painted October 2002

One Goiot hatch on bridge deck (flush mounted and hinged on aft edge)

One Goiot hatch at forward end of aft cockpit - painted Awlgrip October 2002

Ten Goiot windows with special drains drilled - painted Awlgrip October 2002

Two storage lockers in aft cockpit port coaming

Two hatches to lockers at main entrance (starboard locker insulated)

Two lockers under aft cockpit seats (life raft stowage)

Two hatches in helmsman seat

Two hatches to lazarette storage area

Recessed shore power intake with a hatch

ANCHOR WINDLASS

Recessed electric windlass replaced in 2006 with single gypsy and rope drum

Hand control with 3.5m cable

Chain locker with hatch

MISCELLANEOUS AND GENERAL

Vang quick release and Lewmar emergency stop on starboard panel locker

Stainless steel bar as foot support in the aft cockpit (removable)

Stainless steel plate on deck as protection for anchor chain

Steering wheel with double spokes

Deck fittings for harness attachment

Outboard brackets with stainless steel protection

Two teak seats in pushpit corners

INTERIOR

Irving and Lilley specification Swan 77.003 Capercaillie 8 of 25 19/12/2011



GENERAL

All joiner work is done in accordance with the best yacht practice, using first grade materials

Teak with hand rubbed satin finish is used for all visible woodwork

Floorboards with laid teak veneer, providing access to bilge - all have been covered with ProtectaSurface since new

Topsides where visible lined with teak battens

Roller blinds/mosquito screens for hinged deck hatches from 0.5m width upwards

Doors, partitions and panelling throughout are teak faced plywood

Structural battens are of foam cored sandwich construction

Door sills have stainless steel chafing pieces

Self engaging latches with bumpers to hold doors in open position

Irving and Lilley specification Swan 77.003 Capercaillie 9 of 25 19/12/2011

Nautor Brokerage – United Kingdom and Ireland –

Pat Lilley +44 2380 454880; mob +44 7799 117310; Email: pat.lilley@swanyachts.co.uk

Tim Quinlan +44 2380 454 880; mob + 44 7712 049 290; Email: timquinlan@swanyachts.co.uk

Hanging lockers are equipped with rods and hooks and have bottom drawers where possible - doors provided with louvres
Shelves with Perspex or teak front
Nautor made door knobs
GRP and plywood boxes in bilge
Covers for saloon and cockpit tables
Covers for seats in saloon and navigation area
Curtains



FORE PEAK

LPG bottle and general stowage
Watertight collision bulkhead aft



FORWARD GUEST CABINS

Fixed lower double berth with two drawers and a lid
Fold-up upper berth
Hanging locker in starboard side forward
TV and video installed above desk (roll tops), copper tone mirror between deck and TV locker, drawers under desk

CREW CABIN

Roll tops for TV and video

Irving and Lilley specification Swan 77.003 Capercaillie 10 of 25 19/12/2011

Wooden berth on starboard side with lockers and drawers below
Table convertible to double berth
Floorboards lowered 5cm to give height of 193cm
Fold-up upper berth on port side and separate backrest against hull
Full length copper tone mirror on toilet door facing crew cabin
Chain box with lighting
Boarding/bathing ladder on aft bulkhead
NOTE – videos in all cabins replaced with multi region DVD players in Summer 2005.

GALLEY

Corian Sierra Oceanic Blue working surfaces and sliding doors

STARBOARD SIDE

Fridge - plate on backside perforated
Ceramic electric hot plate installed with Corian cutting board with drawers under
Three extra drawers
Force 10 gas stove - New 2002
Microwave - New 2002

PORT SIDE

Locker forward
Stainless steel sinks installed below Corian surface
Waste disposer installed in forward side
Pull-out rubbish bin aft
Stainless steel plate rack with GRP bottom drained to the sink
Upper shelf teak
Freezer - 240 litres, below floorboards
Additional freezer (100 litres) aft of standard freezer

SALOON

Dining table folds and lowers to form coffee table
Starboard aft locker built for entertainment centre
21" TV installed in aft locker on port side
Hull window surrounded by teak
Main entrance ladder with six steps with stainless steel handrails
Polygrip anti-slip material on steps



NAVIGATION AREA

Roll tops for instruments

Horizontal chart stowage

Storage drawer in navigation seat

Irving and Lilley specification Swan 77.003 Capercaillie 12 of 25 19/12/2011

Nautor Brokerage – United Kingdom and Ireland –

Pat Lilley +44 2380 454880; mob +44 7799 117310; Email: pat.lilley@swanyachts.co.uk

Tim Quinlan +44 2380 454 880; mob + 44 7712 049 290; Email: timquinlan@swanyachts.co.uk



CAPTAINS CABIN

- Lower berth with two lids on front
- Settee/berth starboard side
- Hanging lockers each side with drawers below
- Isolation of aft bulkhead
- Upper berth of Pullman type
- Safe with combination lock (A4 internal size)
- Passage door with stopper in open position



Irving and Lilley specification Swan 77.003 Capercaillie 13 of 25 19/12/2011



OWNERS CABIN

Double berth of dimensions

- length - 200cm

- width at foot end = 120cm

- width at middle = 132cm

- width at head end = 162cm

Height = 70cm

Drawers and locker under berth

Hanging locker and locker with shelves on port side with drawers below

Locker above double berth on port side

TV installed in the middle aft with roll tops

Desk with locker under TV

Video and stereo set starboard of TV with roll tops

Sofa on starboard side with lockers above

Coffee table

Hanging locker forward in the middle with shelves to starboard - lockable door

Copper tone mirrors on forward bulkhead and hanging locker door

HEADS

Crew Cabin

Mirror behind toilet

Par toilet with hand pump

Owners, Guest, and Captains Cabins

Vacuflush system

Drawers beside wash basins

Corian Sierra Oceanic Blue horizontal areas with Glacier White basins

Irving and Lilley specification Swan 77.003 Capercaillie 14 of 25 19/12/2011

Perspex shower screens come out to basin counter edge and cover upper section
Tiles for toilet compartments
Two small vertical hand holds and one long towel rail of white plastic
Shelves in white Perspex
Small rubbish bin on back of locker door below sinks



ENGINE

GENERAL

Engine space internally sound insulated
Drip tray with manual discharge pump under engine
Propeller area sound insulated

MAIN ENGINE

Perkins 4 M240 Ti 164 kW/220BHP (New recondition engine fitted in Palma October 2006 by Palma Perkins Agent) with Hurth HSW 800 A (new 1999) reverse/reduction gear 2.85:1

EXHAUST SYSTEM

Wet exhaust system with fibreglass silencer, discharge under transom

COOLING SYSTEM

Thermostat controlled fresh water-cooling with heat exchanger (new 2002)
Discharge through exhaust system

FUEL SYSTEM

Fuel capacity 1740 litres in two tanks with filter lines and shut-off valves for each tank and remote shut-off valves installed 2001
Fuel valve chest with return valve for each tank
Two Racor 2010 fuel filter/water separators with water alarm on feed lines to engine and KWA-50 for diesel generator

Irving and Lilley specification Swan 77.003 Capercaillie 15 of 25 19/12/2011

Fuel transfer pump

STARTING SYSTEM

The engine and diesel generator have their own starting battery sets - New 2002

Main engine with spare starter motor

ENGINE COCKPIT CONTROLS

Engine control On/Off

Start and stop buttons

Paralleling button for start and service batteries

Single lever control of throttle and gear shift

Coolant temperature gauge

Oil pressure gauge for engine

Warning light and audible alarm for low oil pressure/high coolant or exhaust temperature

Control light for starting and service battery charging

Fuel tank gauges

STERN GEAR

Propeller shaft made of high tensile corrosion resistant steel with flexible shaft coupling (New 2000)

Three bladed propeller type Max Prop

Shaft seal type OSS high speed 2" - New 1999

PLUMBING

GENERAL

Sea water hoses of reinforced PVC tubing

Fresh water hoses of nylon and copper tubing

All fuel and water tanks are of welded stainless steel and provided with baffles, inspection covers, sounding plug and vent pipes

Shower sump tanks are of GRP, integral with the moulded floor liner

FRESH WATER SYSTEM

Fresh water capacity 1740 litres in two tanks with one filler line from the deck and suction pipes on two levels on one tank

Empty water alarm

Tank vent pipes end at galley sink

Sigmar water heater with capacity of 80 litres, 1.2 kW - New 2000

Deck shower in aft cockpit on starboard side for fresh and sea water with permanent connected hoses - New 2002

Deck shower in aft platform - New 2002

Second water pressure pump installed in parallel - New 2002

Drinking water purifier with outlet in galley

Additional city water connection on deck opposite antenna post on starboard side

WATERMATER

Sea Fresh water maker H2012A - 4500 litres per day - New March 2001

Irving and Lilley specification Swan 77.003 Capercaillie 16 of 25 19/12/2011

SEA WATER SYSTEM

Flowjet deck wash pump
Seawater spout in galley with 2m hose

DRAINAGE SYSTEM

Galley sinks drained through seacock
Wash basins and showers drain to sump tanks - capacity about 70 litres each
Sump tanks emptied by electrical pump or manual Whale pump
Outlet above waterline

BILGE PUMPS

Three bilge pumps - two manual type Whale Gusher Titan and one electric submersible type Jabsco 4000 with automatic switch
One additional bilge pump - electrical Par with automatic switch
Engine driven bulge pump (Jabsco)
Food waste disposer - type Disperator 77 - New 2001
Auto stop with vacuum switch for sump tank pumps

TOILETS

Vacuflush 506 toilets with connection to freshwater system
Crew toilet - manual PAR
Midships toilet starboard side - discharge alternatively to stainless steel holding tank
Holding tank emptied by electrical Vacuflush pump
Deck suction
Mistral over head showers
Sump tank pumps

VENTILATION

GENERAL

Natural ventilation in cabins with Dorade type inlets - all with Hella Turbo fans
Exhaust ventilators in heads and in galley with Hella Turbo fan

ENGINE ROOM

Air inlet water trap, outlet with blower installed with remote shut-offs for MCA in 2000
Separate outlet for diesel generator cooling air installed with remote shut-offs for MCA in 2000

BATTERY BOXES

Ventilated to mast

AIR CONDITIONING

Marine Air air-conditioning type Vector VHE 12-H, 220VAC with ECU-VR control units - total capacity 48000BUTU including shore power intake
Irving and Lilley specification Swan 77.003 Capercaillie 17 of 25 19/12/2011

- One unit for Owners and skipper cabin
 - Two units for saloon and aft guest cabin
 - One unit for galley and crew cabin
 - One unit for forward guest cabin
- Possibility to run fans via inverter

REFRIGERATION

220V refrigeration/deep freeze unit with single 30D compressors
Refrigeration system was overhauled in 2006 with a new engine driven compressor.

Freezer under floorboards in galley - 240 litres

Additional freezer aft in galley - 100 litres under floorboards

Electric pump for fridge drainages

The new drinks fridge has a freezer compartment for ice making

ELECTRICAL

GENERAL

24V DC system with two-wire insulated return

New service batteries September 2000

Wires are dimensioned to minimise voltage drop

220C AC is a three-wire system

For lightning protection, the headstay, backstay, main shroud chain plates and mast step are grounded to ballast keel bolts with heavy cable

ELECTRIC CONSUMERS

Inverter Mass 1500 VA 24/220V for TV and video - New Mass 2500VA 2001

Inverter Mass 3000 VA 24/220V including transfer switch for microwave, trash compacter

Miele Washing machine only - no dryer

Westerbeke 20 BED-514 220V 50Hz with power take off for Commander

Dolfin and Lombardi 220V 50Hz No 2 Gen 8kVA - New 2001

Electric ceramic hot plate and galley extractor

Separate battery bank 320Ah for radios including charger MASS 24/50 - New 2002

Miele microwave

Diving compressor - Bauer Purus

220V outlet in printer drawer for VHD charging

Note June 2009:

New 24/50 Radio Battery Charger (Mastervolt)

Another New 24/70 Service Battery charger (Mastervolt)

2 x 12V Starter batteries for Westerbeke generator

1 x 12V Starter Battery for Lombardini generator

PUMPS

Electric bilge pump - submersible - and PAR pump

Water pressure pumps - New October 2002

Irving and Lilley specification Swan 77.003 Capercaillie 18 of 25 19/12/2011

Sump tank pumps
Deck wash pump
Holding tank discharge pump
Four toilet vacuum pumps

FANS
Engine room
Diesel generator
Heads
Galley

DC Motors
Auto pilot hydraulic pump

PANELS AND CONTROLS

DC Main Panel
Located near the navigators space and protected by Perspex doors
Switches of trip-free circuit type
V- and A-meters of digital type
Main switch and fuses located in locker near switchboard
Switches for interior and navigation lights
Bilge water warning light with audible alarm

Cockpit Panel
Switches for mast flood light, spreader lights and foghorn
Remote gen controls and power take-off

Diesel Generator
Diesel generator controls with oil pressure, coolant temperature, hour and V-meter

AC Panel
Located near the DC panel and protected by a Perspex door
Switches of tri-free circuit type
One V-meter
One frequency meter
One A-meter

LIGHTS

Interior
Light dimmer in Owners cabin (two in saloon)
Lights beside mirrors in heads
Two Luff lights
Reading bed lights and bulkhead lights

Exterior
Nav lights - side, stern, bow and masthead
Spreader lights
Irving and Lilley specification Swan 77.003 Capercaillie 19 of 25 19/12/2011

Floodlight down
Windex light
Windlass locker light
All deck locker lights

INSTRUMENTATION

NAVIGATION

B&G Hydra Cruise Pack - plus extras comprising:

- Sonic transducers (excluding Hydra Cruise package sensor)
- Sea temperature sensor
- Depth transducer
- Masthead unit
- Halcyon compass sensor
- 6 x FFD (one piece in the package) positioned as:
 - 1 x crew quarters
 - 1 x skippers cabin
 - 2 x chart table
 - 2 x compass crash bar
- 6 x 20/20 displays positioned as:
 - 3 x companionway
 - 3 x mast
- Analogue 360 wind display starboard of mainsheet winch
- Analogue 45 magnified wind display starboard of mainsheet winch

NOTE – 2 B and G units at wheel replaced 2005.

Additional depth transducer forward of rudder with change-over switch
Shipmate GMDSS Dual station Sigmar VHF radio telephone (new Summer 2005)
Antenna installed at the top of the mast and loud speakers on the deck and at the chart table
AP Phillips Mk 6 GPS navigator
Raymarine Radar is interfaced with the E120 Chartplotter 2008/09
Barograph - Sprecher Meteostar (Electronic)
Windex and light
New 2009 Raymarine E120 chart plotter to nav station

COMMUNICATION

SSB Sailor radio telephone connected to insulated backstay
New Iridium satellite handset - 2006
NMT antenna on the mast including wiring to navigation area and converter

ENTERTAINMENT SYSTEM

Pioneer stereo mixing amplifier
Alpine woofer/tweeter loud speaker combination - one in each corner of the saloon
Alpine car/stereo/CD changer/equalizer combination connected through the mixing amplifier
2 guest cabin and 1 crew cabin TV replaced summer 2005.
Irving and Lilley specification Swan 77.003 Capercaillie 20 of 25 19/12/2011

Pull down screen width 160cm on port side
DVD player

OWNERS CABIN

Alpine car stereo/CD changer/ equaliser combination
Two Alpine 3-way loudspeakers
TV and Video

CREW CABIN

Alpine car stereo/CD changer /equaliser combination
Two Alpine 3-way loud speakers
TV, VCR
Forward Guest Cabin
TV. VCR
Aft Guest Cabin
TV, VCR

COCKPITS

Two Sony waterproof speakers in aft cockpit and two pieces in forward cockpit with
QEM speaker switch and stainless speaker covers

RIG

MAST

New mast and all standing/running rigging - May 2000
4-spreader mast
I = 31.0m P = 28.4m E = 9.1m
Oval section with external stemball tang and Harken 758 track for full batten
mainsail
Tapered and welded masthead with two spinnaker cranes and three halyard
sheaves
Internal wiring shielded in PVC tubes secures to mast
Open spreaders with adjustable longitudinal angle
Spinnaker gooseneck tract on forward side
One toggle pin for jockey pole
Neoprene mast boom with Dacron cover over adjustable deck partners

BOOM AND POLES

Main Boom

Oval tapered white painted section with internal three part outhaul led to Lewmar
30 CST winch and arranged for slab reefing with three reefing lines

Poles

One spinnaker and one jockey pole (painted - Awlgrip October 2002) of round
white painted section with appropriate fittings
Spinnaker pole in carbon fibre

Irving and Lilley specification Swan 77.003 Capercaillie 21 of 25 19/12/2011

HYDRAULIC SYSTEMS

Hydraulic furling headstay (Reckmann RF90-3 profile R5)
Navtec hydraulic system VI including Cunningham, outhaul in main boom and radar adjustment
Quick release for vang
Try-sail track on port side of mast

SAILS

Doyle Main 2001
New #1 - Doyle D4 - not used as Dec 2006.
#2 1993 battened – condition unknown
New #3 Elvstrom Sobstad 2006
#4 1993 – serviceable for deliveries
Spinnaker 0.75 oz 1993
Spinnaker 1.4oz 1993

EQUIPMENT AND MISCELLANEOUS

Cockpit table in centre cockpit
100m of 12mm high tensile chain
Spray hood for main companionway and aft cockpit with clear vision panels front and sides (Heights 157cm) and a zip on aft edge
For all berths except pipe cost, canvas or teak leeboards and mattresses
Halon total flooding system for engine and generator space with remote control at entrance
Hard weather safety lines
Gangway - Whittall 3m folding teak to be stowed in bow locker
Stainless steel bars in forward locker
Fire extinguishers
Cockpit cushions for aft and centre cockpit with backrests cushion to cover cockpit table and cushions for pushpit seats
Canvas covers for the compressor, gangway and fenders
Portable bilge pump
Banana, donut and mantaray for towing behind rib

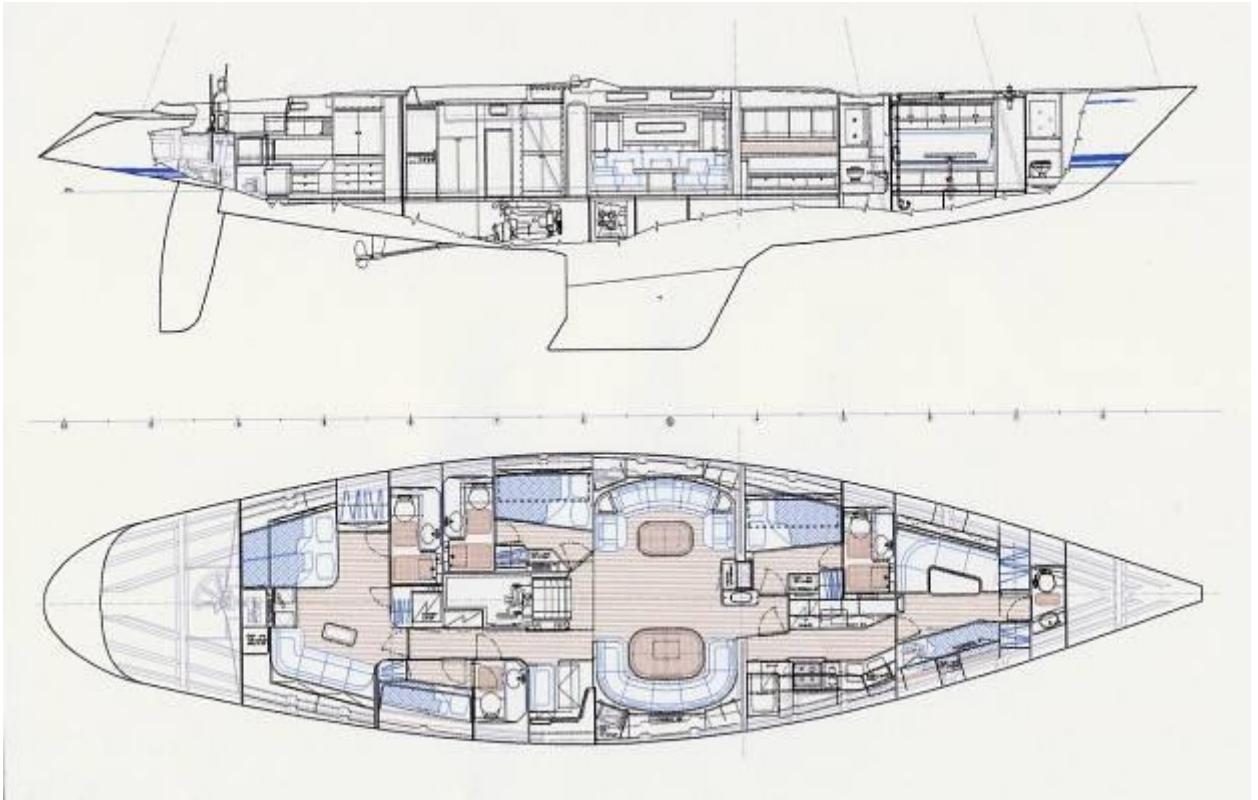

Owner crew/kids guest saloon guest and galley crew



Irving and Lilley specification Swan 77.003 Capercaillie 23 of 25 19/12/2011



Irving and Lilley specification Swan 77.003 Capercaillie 24 of 25 19/12/2011

Nautor Brokerage – United Kingdom and Ireland –
Pat Lilley +44 2380 454880; mob +44 7799 117310; Email: pat.lilley@swanyachts.co.uk
Tim Quinlan +44 2380 454 880; mob + 44 7712 049 290; Email: timquinlan@swanyachts.co.uk



NOT INCLUDED IN SALE

Personal effects, including, personal tools, cutlery, crockery, glassware

Draft #3 TJQ . 22nd June 2011. Confirmed by skipper.

The Company offers the details of this vessel in good faith but cannot guarantee or warrant the accuracy of this information nor warrant the condition of the vessel. A buyer should instruct his agents, or his surveyors, to investigate such details as the buyer desires validated. This vessel is offered subject to prior sale, price change, or withdrawal without notice.

Irving and Lilley specification Swan 77.003 Capercaillie 25 of 25 19/12/2011