

SWAN 57/043

Serena B

YEAR: 1982

(Name to be retained by Owner)

The following is the specification and inventory that will be supplied with the vessel for sale.

The general specifications are:

Length overall: 17.50m (57.41')
Length water line: 13.96m (45.81')
Beam: 4.83m (15.85')
Draft: 2.8 m (9.1')
Displacement: 22,500 kg (49,500 lbs)
Ballast: 8,600 kg (18,900 lbs)
Fuel: 570 Litres Water: 725 Litres

Engine: Perkins M90 (new 1997)

Designer: Sparkman and Stephens

Location: Puerto De La Duquesa

Price: 295,000 Euros VAT exempt

Comments:

The yacht, one of the original classic Swans was launched in June 1982 and has been meticulously maintained and professionally run for the last 12 years. Serena B has held dual DOT/MCA Small Commercial Vessel Certification. Category 1 (150 miles offshore) for 14 persons and Category 4 (20 miles offshore) for 16 persons. Note, she is not currently in classification but the inventory includes most items required for re-validation.

In her life Serena B (ex Noonmark V) has sailed many thousands of miles around the globe and more recently been operated as a luxury private corporate and race charter yacht. She has competed with considerable success in all the Fastnet races from 1993 – 2001; the 1992 Round Britain Race; Cork Week Regattas; St Tropez Nioulague Regattas, the Swan World Cup in Sardinia and Swan European Championships in Cowes.

As a race charter entrant she has competed in Cowes Week Regattas since 1993 to 2003.

During the winter of 2002/2003 Serena B has undergone an extensive refit, bringing her back to full concourse condition. New teak decks, deck hardware, new anodised aluminium toe rails and a complete hull and coachroof respray will ensure she remains one of the most beautifully presented Swans afloat.

Below decks she is very spacious with a large saloon area around which is possible to seat 10 people comfortably and 8 for meals. The saloon houses a flat screen television, video and “Bose” stereo system, with speakers below and on deck. At the aft of the yacht there is a sea kindly owners cabin with one double and one single berth, en-suite head and shower, vanity unit and small settee. There is access to the cockpit from the aft cabin. Forward of the saloon are two guest cabins, which both have en-suite WC and shower. Both cabins contain two single berths one above the other with plenty of wardrobe and cupboard space. The fo’c’sle has two folding aluminium pipe cots for crew and ample sail storage.

To the starboard side and aft of the saloon is the navigation area, housing all the modern electronic aids one would expect of a vessel of this pedigree.

Serena B has one fully equipped container, fitted out with racking system, hanging bars for storage and workstations and may be available with the yacht.

She has received very light usage in her current ownership and is presented in quite superb condition.

HULL

- The hull is of single skin construction and made of glass reinforced polyester laminate. Finish is in Flag Blue Awlgrip (2003) paint with white boot top and cove line stripes
- Antifouling is VC Offshore Extra Red over a full epoxy protective system applied in 2000
- Keel is a lead casting alloyed with antimony. Cast in keel bolts are of high tensile stainless steel. Keel removed and all bolts inspected Winter 2000
- Rudder is foam filled FRP with stainless steel stock supported by 3 polymer bushed bearings. All bearings replaced in 2000
- S/S destroyer type wheel with new Elk hide cover. Cable steering with chain drive

DECK

- Two Awlgrip Flag Blue painted coaming stripes

Teak Woodwork

- 2001 9mm teak on side deck, bridge deck, coach roof, cockpit coaming and on cockpit soles and seats. Non-screw full epoxy bonded 'Moody's Teak Deck System'



Deck Hardware

Lewmar Winches

- 1 x Lewmar Vertical Holdfast Power windlass model 2500 including gypsy, capstan, S/S cover guard and cover
- 2 x Lewmar 48 ST Chrome – Reefing and Spinnaker Up/Down Haul Winches
- 2 x Lewmar 55 ST Black Alloy – Genoa Halyard Winches
- 2 x Lewmar 48 ST Chrome – Spinnaker Halyard Winches
- 1 x Lewmar 55 ST Main Sheet Winch
- 1 x Lewmar 46 ST Black Alloy – Main Traveller Winch
- 2 x Lewmar 70 ST 3 Speed Chrome – Spinnaker Sheet Winches
- 2 x Lewmar 48 ST Chrome Runner Winches
- 1 x Lewmar 52 ST Mainsail Halyard Winch – Mast Mounted
- 1 x Lewmar 8 Chrome – Mainsail Outhaul Winch – Boom Mounted
- 2 x Barient 90 3 speed ST Winches, linked to two customised Barient Coffee Grinder Pedestals. Winches can also be driven by 4HP electric motors with deck mounted push button controls

Mainsheet

- Lewmar Ocean 3 Beam Track with custom built re-circulating Tordon ball car and integral Traveller control line system with Spinlock jammers
- 4 x Lewmar Ocean 3 Mainsheet Blocks on Traveller and Boom Bail – 4 part system

Genoa Sheet

- Lewmar Ocean 3 Genoa track and separate Staysail tracks on coachroof (new 2003)
- 4 x Lewmar Ocean 3 Genoa Cars and end stops (new 2003)
- One pair double Genoa foot blocks on aluminium bases

Mast Base Blocks for Halyards

- Nautor original upstanding blocks with custom S/S cheeks and Delrin sheaves

Spinnaker System

- Nautor double spinnaker sheet Spreader blocks with S/S cheeks
- Fredriksen 125 Orbit block and strops for spinnaker guy

Deck Equipment

- Combined bathing/side boarding ladder in S/S and teak
- Toe rail fittings for boarding ladder at lifeline gate
- Lacing and sail rollers from No 3 stanchion forward
- Nautor 16" mooring cleats, fairleads and chocks, one pair forward, one pair aft
- Stanchions foot rollers for Reckmann furling line
- S/S anchor bow roller
- Paserelle fitting aft
- S/S polished radar post mounted on the aft deck. Radar pole incorporates aerial strut for VHF, Weather Fax GPS, Sea Marshall PBL7 tracking aerial
- S/S mug holder and bottle holders on steering pedestal
- S/S grills for cockpit and deck speakers
- Deck lockers both sides of cockpit
- Removable aft folding cockpit table
- Anodised aluminium toe rail with one pair of hawse holes amidships and drain holes (new 2003)
- S/S Halyard organiser in front of mast
- S/S guards over Dorade boxes
- Release lever box on foredeck for forestay

Hatches & Windows

- On foredeck tinted acrylic sliding hatch to fo'c'sle, lockable from inside 70cm x 80cm (new 2003)
- Deck prism and hatch Goiot 36cm x 19cm in head and adjacent passageway
- Two hinged hatches Goiot 115 in guest cabins
- Hinged hatch Goiot 118 in main cabin
- In coachroof sides fixed windows forward, one pair of openable portholes Goiot 103 aft
- Main companionway sliding hatch of tinted acrylic lockable from inside and outside and large enough for passing engine
- Aft entrance Lewmar hatch of tinted acrylic lockable from inside
- One openable porthole Goiot 108 from owner's cabin to cockpit
- Three hinged undersea lockers in cockpit for storage, one being a dedicated gas

locker

- One large locker in cockpit for life raft and lift up seats for lazarette access

INTERIOR

Layout

- Master cabin with double berth to port. Access from aft end of double berth to lazarette. Single berth to starboard. Teak chart storage unit and generator cover between bunks. Dresser with mirror on forward bulkhead. Small seat forward of generator case and separate settee seat to starboard and forward of single bunk. Double hanging locker and drawer storage. En-suite head and shower
- 1 x guest cabin forward starboard side with 2 single berths one above the other. Wardrobe and hanging space and lockers and drawers. En-suite head and shower
- 1 x guest cabin forward portside with 2 single berths one above the other. Locker and drawer space. En-suite head and shower
- Crew area in fo'c'sle with sail bins under folding aluminium pipe berths. Steps below hatch
- Galley area with twin S/S sinks, Taylor 041 gas stove with oven grill and two burners, gimballed and provided with fiddles contained in an insulated sheaved fireproof space. Iceberg refrigeration. Top and front loading refrigerator. Top loading freezer. Refrigeration is a dual system and can be run by either the 24v engine drive compressor or the 230v generator/shore power operated unit. Counter tops are in cream Formica. Gas detector and electric fan. Ventilation via opening Giot hatch 30cm x 19cm and electric extractor fans
- The saloon has a drop leaf table positioned slightly to starboard with sofa seating around forward, starboard and aft sides with storage lockers and bookcase outboard. The port side has a sofa. A large pilot berth is situated outboard of the settee berth
- Navigation area is to starboard with waterproof locker behind
- Hinged wooden companionway ladder with storage box behind and access to engine cover
- Cabin sole is made of teak veneer floorboards. There is one set of 4mm thick PVC protective floor covering
- All bunk mattresses and cushions have separate custom made protective acrylic covers for racing and during maintenance

Soft Furnishings

- Saloon cushions and seat backs are covered in a blue and white stripe fabric
- Saloon curtains are in plain ivory, and all other bunk mattresses are covered in a dark blue material
- Scatter cushions in blue and white

RIGGING

Spars

Nautor mast of elliptical section, aluminium anodised, jointed at half length. Two sets of tapered spreaders. S/S custom bracket for 2 x 20/20 B&G repeaters

- Mainsail track for 1" internal slides riveted to mast
- Spinnaker gooseneck and track on forward face
- Boom – anodised aluminium Formula Spars boom
- Spinnaker poles x 3. 2 x Nautor aluminium anodised poles and 1 x Carbo Spars

- aluminium painted carbon pole
- Jockey Pole – Nautor anodised aluminium

Standing Rigging

- Main and upper shrouds, forestay and backstay are of solid Navtec rod. Forward and aft lowers 1 x 19 wire with Norseman terminals
- Reckmann RS 2000/40 forestay furling system – removable for racing
- Separate rod forestay with Tuff Luff foil for racing
- Wire runners and inner forestay

Hydraulic System

- Navtec hydraulic panel; 2 function unit cockpit mounted
- Navtec backstay ram
- Navtec boom vang ram

Running Rigging

- 2004 Spectra and Vectran genoa and staysail halyards
- Spectra spinnaker and mainsail halyard and spinnaker topping lift
- Spectra genoa and spinnaker sheets and guys

ENGINE

- Perkins four cylinder M90 marine diesel output 63Kw/84hp at 2,800 revs. (new 1997)
- Removable engine box internally sound proofed
- Wet exhaust discharge through transom
- Fuel capacity 860 litres in 3 S/S tanks with filler manifold system
- Water separator in fuel line. Tanks vented to deck
- Three bladed 23" Max prop folding propeller
- The cockpit contains the engine on/off controls, Morse single lever throttle and gearshift. Control lights for starting, coolant temperature with alarm, oil pressure with alarm, oil pressure with alarm and tachometer with hour meter

PLUMBING

- Water capacity 725 litres in 3 stainless steel tanks. One filler with under floor valve chest
- Hot water calorifier 60 litre capacity
- Water can be heated with engine cooling water or 230v heating element
- "Watermaker/Seafresh" water maker, 230v driven 3500 litres per day – new membranes 2004.
- Hot and cold shower in cockpit
- Sea water deck wash pump and fire hose in cockpit
- Hot and cold mixer taps in galley and heads. Shower mixers in heads
- Bilge pump system; Whale gusher 10's in cockpit and at chart table. Electrical Rule 2000 with automatic float switch
- Two Baby Blake manual heads aft and forward starboard and one Jabsco 'Slimline' head forward port

ELECTRICAL DC System

- Service battery set 400Ah, 5 hour rating 24v traction type for general service
- Engine starting battery 95Ah 24v
- Generator starting battery 90Ah 12v

Charging

- Engine driven service alternator 95amp with electronic regulator
- Engine driven engine alternator 70amp
- Mastervolt 70amp battery charger with automatic regulation, capable of being run off either generator or shore supply

AC System

- Fisher Panda 12Kw diesel generator
- 230v 50A/125v 30amp shore power inlets with land connecting cable
- Mastervolt AC inverter

Electric Consumers

- Fresh water heater 240v element
- Overhead lighting throughout, bulkhead mounted bunk reading lights
- TV, video and stereo system
- Navigation equipment, lights and deck lights
- Comprehensive circuit breaker and switches for all 240v/24v electrical system
- 230v 13amp outlets throughout yacht
- Flat screen TV and Bose sound system – new 2004

Heating

- Eberspacher D5LC diesel heating system with 4 outlets in saloon forward and aft cabins and waterproof locker

ELECTRICAL INSTRUMENTATION

Brookes & Gatehouse Instrumentation

- B&G Hydra 330 system
 - B&G Hercules 690 Processor
 - B&G Performance Processor
 - B&G Paddle wheel and echo sounder transducer with gravity switching
- B&G FFD displays (x 4)
- B&G 20/20 displays (x 2)
- Remote button to change 20/20 displays (x 2)
- B&G Super Halcyon 3 electronic compass
- Analogue displays '360° wind direction', 'magnified wind', 'boat speed' and 'wind speed'
- B&G Wand Anemometer

Radio Communication

- Sailor HF RE 2100 SSB radio
- Sailor PT 2047 VHF radio

- GSM Motorola Cell Phone
- Navico 'Axis' handheld VHF and charger

Navigation Equipment

- Furuno Model 1721 radar fitted to aft deck post and interfaced with GPS
- Furuno weather fax Fax-208/A/N with Navtec
- Furuno weather receiver NX-300 (518 KHz and 490 KHz)
- Leica MX400 Differential GPS
- Furuno GP-30/35 Differential GPS
- 'Sea Marshall' PLB7 man overboard monitor aerial and 15 personal beacons
- Bulkhead mounted chronometer and barometer
- 'Neco' 24v NM692 MKIII autopilot

Entertainment

- Philips video player and recorder
- Stereo/Radio/Cassette/CD player
- Bose speakers in saloon
- 4 weatherproof outside cockpit speakers
- Control system for sound generation

Aerials

- Masthead VHF aerial. TV/FM radio masthead aerial
- Radar pole. Radar weatherfax, GPS, Sea Marshall aerials
- Masthead Delta 1000s antenna, GSM phone

SAIL WARDROBE

Mainsails

- Spectra Race main – 2001/02
- Storm trysail - good condition

Headsails

- Furling Spectra #1 – 2001
- Furling Spectra Yankee #3 – 2001
- Storm jib and staysail
- North 3DL med #1
- North Mylar Dacron #2
- Williams & Lancaster #4 blade

Spinnakers include

- 0.75 oz
- 1.2 oz
- 1.5 oz
- 2.2 oz
- 1.5 oz cruising chute MPS with snuffer

EQUIPMENT

General

- Hinged table for aft cockpit

Anchoring & Mooring

- Lewmar Vertical Holdfast power windlass 2500 with air pushbuttons on bow and remote cockpit control
- Main anchor 60lb CQR 70 meters of 12mm high tensile calibrated chain and a race rode consisting of 100 meters of 25mm multiplait nylon and 10 meters of 12mm chain
- Kedge anchor 35lb CQR 10 meters of 12mm high tensile chain and 50 meters of 25mm multiplait nylon
- 6 fenders
- 2 canvas fender skirts
- Folding boat hook and storage in fo'c'sle

Canvas Work

- White acrylic canvas sprayhoods over both main and aft companionways
- Aft cockpit Bimini
- Blue acrylic full winter cover for yacht. Bow to stern with clear windows and zipped entrance doors
- Boom cover in navy blue acrylic
- Pedestal and steering wheel cover in navy blue acrylic
- Dark blue vinyl cockpit cushions for aft cockpit
- Navy blue acrylic waterproof covers for all saloon bunk and cabin cushions
- Navy blue acrylic race covers for protecting companionway, navigation bulkhead and saloon table
- New 2004 windscoop

Safety Equipment

- Liferafts 1 x 10 man
- EPIRB Satellite 2406 – ARC electronics
- Two webbing jackstays
- Distress flares.
- Fire extinguishers throughout the vessel
- Bolt croppers
- Fog horn

NOT INCLUDED IN SALE

Personal effects, including, personal tools, cutlery, crockery, glassware

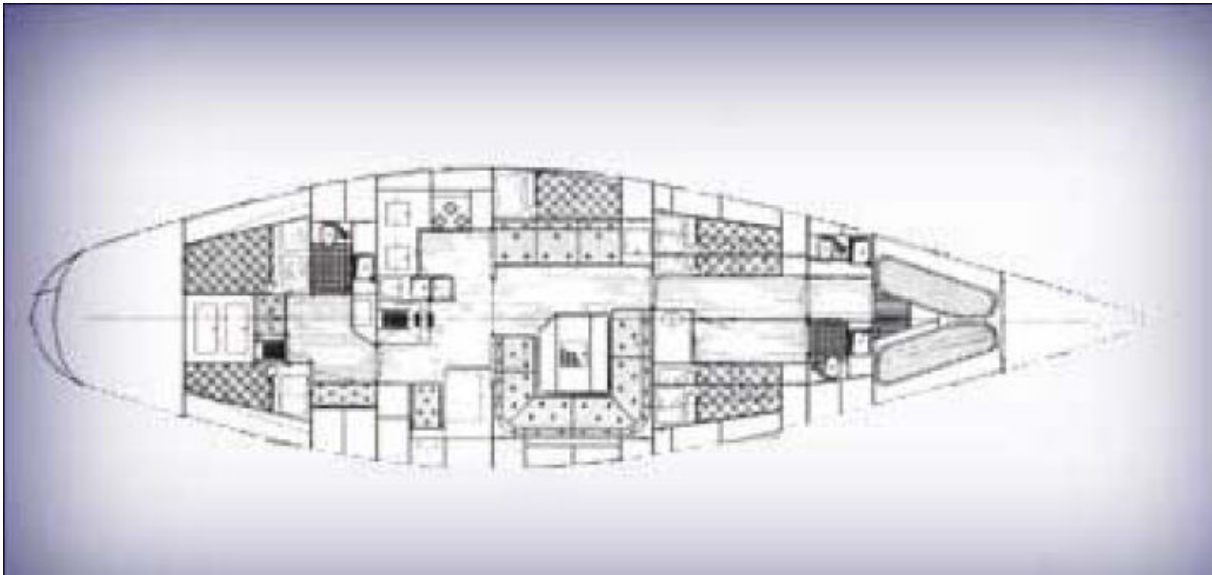

Draft #1 TJQ 29th April 2009. Confirmed by owner.

The Company offers the details of this vessel in good faith but cannot guarantee or warrant the accuracy of this information nor warrant the condition of the vessel. A buyer should instruct his agents, or his surveyors, to investigate such details as the buyer desires validated. This vessel is offered subject to prior sale, price change, or withdrawal without notice. This specification/inventory will only form part of the contract when attached to a bona fide sales contract that has been signed and agreed by both seller and buyer.